

AREA PLAN

40-44 NEWMAN STREET

LONDON, W1

Fifth Floor

IPMS3 Office Area Plan

IPMS3	150.6 sq m	1621 sq ft
-------	------------	------------

LIMITED USE AREAS

The following areas are 'Limited Use' Areas within the TOTAL Area:

Internal Dominant Face (IDF)	3.7 sq m	40 sq ft
Structure	0.1 sq m	1 sq ft
Restricted Headroom	3.3 sq m	36 sq ft

Net Internal Area

NIA	143.6 sq m	1546 sq ft
-----	------------	------------

The following has been EXCLUDED from the TOTAL NIA:

Restricted Headroom	3.3 sq m	36 sq ft
---------------------	----------	----------

Gross Internal Area

GIA	187.7 sq m	2020 sq ft
-----	------------	------------

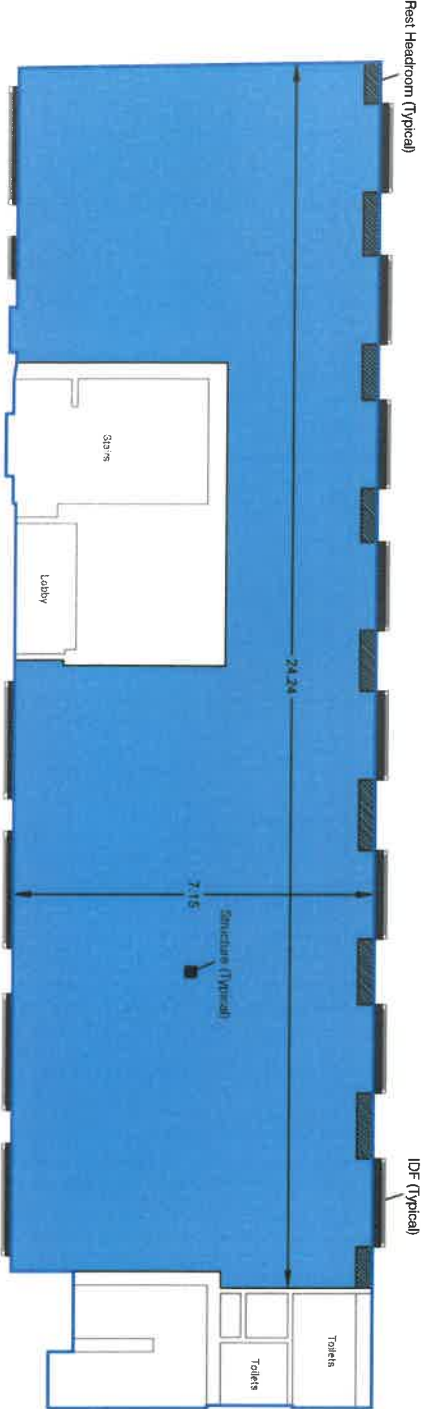

Notes:

(X) Floor to Ceiling Height (Metres)

A dashed line denotes assumed - Inaccessible due to fit out.

This drawing indicates the extent of the areas quoted, produced to an accuracy commensurate with standard presentation scales. It is held in a scaled digital CAD format.

Dwg No. LF2892-AREA-05

Issue A November 2020

Scaled for presentation - 1:100 @ A3

NEWMAN STREET